

EXHAUST SYSTEMS

ALL MODELS

CONTENTS

Subject	Page No.
DESCRIPTION AND OPERATION: (Not Applicable)	
DIAGNOSIS: (Not Applicable)	
MAINTENANCE AND ADJUSTMENTS: (Not Applicable)	
MAJOR REPAIR:	
Exhaust System (All Models)	6D-42
SPECIFICATIONS:	
Torque Specifications	6D-42

MAJOR REPAIR

EXHAUST SYSTEM (ALL MODELS)

Removal

1. Remove exhaust pipe from exhaust manifold.
2. Loosen front exhaust pipe to **muffler** clamp and pull exhaust pipe out of muffler.
3. Remove muffler damper rings.
4. Remove center exhaust pipe clamp. Remove rear **muffler** and tail pipe(s) as an assembly. See Figure 6D-1.
5. Remove front exhaust pipe clamp, and remove front muffler and center exhaust pipe as an assembly, then remove center exhaust pipe from front **muffler**.

The front **muffler** and center exhaust pipe are one piece on production-built cars but are separate items for service, the tail pipe of the Rallye and GT, has a dual pipe with one resonator.

Installation

Check rubber damper rings for muffler and tail pipe hanger and replace as necessary.

1. Coat I.D. of rear **muffler** inlet neck and O.D. of center exhaust pipe outlet (rear of pipe) with exhaust sealer compound (several brands are currently available on the market).

2. Insert center exhaust pipe into rear **muffler** and tighten clamp.
3. Coat I.D. of front muffler outlet neck and O.D. of center exhaust pipe inlet (front of pipe) with exhaust sealer compound.
4. Insert center exhaust pipe into front **muffler** and tighten clamp.
5. Install muffler and tail pipe assembly on rubber damper rings and tighten hangers. See Figures 6D-1 and 6D-2.
6. Install front exhaust pipe into muffler. Do not tighten clamp.
7. Be sure to install gasket between exhaust manifold and exhaust pipe. Using bolts with washers, attach the exhaust pipe to the exhaust manifold. Torque to 15 lb.ft.
8. Align exhaust system and tighten all clamps.
9. Check alignment of exhaust system; make sure that the exhaust system components have at least 3/4" clearance from the floor pan to avoid possible overheating of the floor pan.

SPECIFICATIONS

TORQUE SPECIFICATIONS

Exhaust Pipe to Exhaust Manifold • 15 lb.ft.

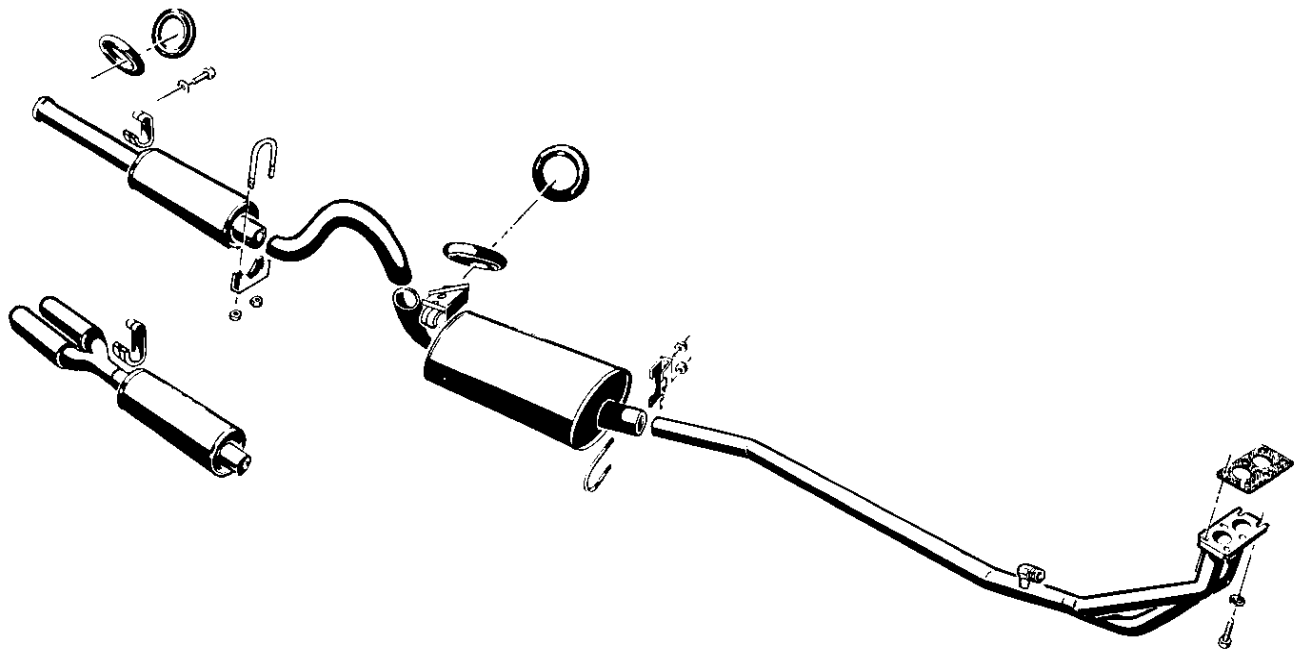

6D-4

Figure 6D-1 Opel 1900 and Manta Exhaust System

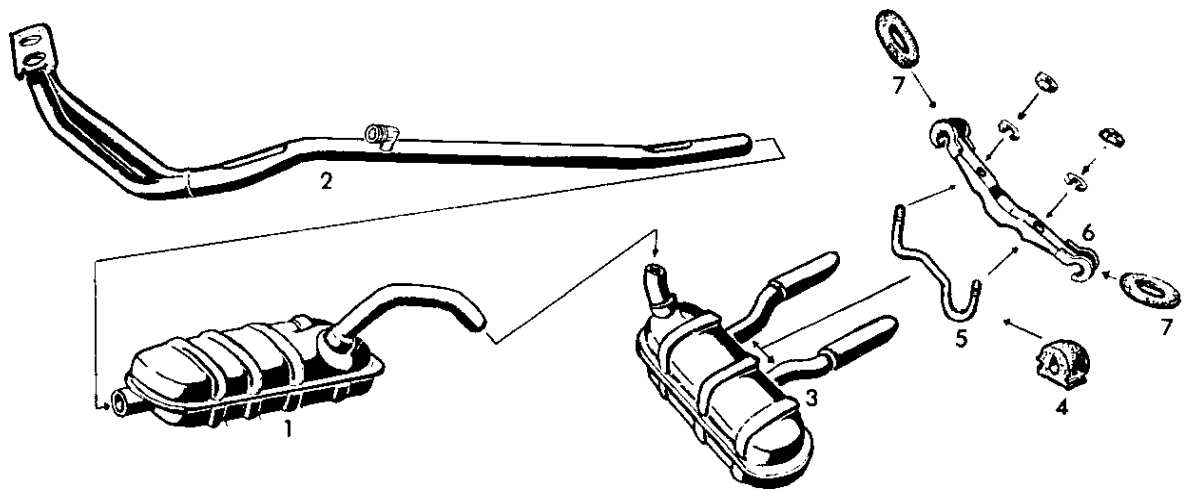

G.T. — EXHAUST SYSTEM

KEY

DESCRIPTION

- | | |
|---|---|
| 1 | MUFFLER, FRT. W/CTR. EXHAUST |
| 2 | PIPE, FRT. EXHAUST |
| 3 | MUFFLER, RR. W/TAIL PIPE |
| 4 | BUMPER, MUFFLER SUSPENSION — RR. |
| 5 | BOW. MUFFLER SUSPENSION — RR. |
| 6 | BRACKET, MUFFLER SUSPENSION — RR. |
| 7 | DAMPER RING, MUFFLER SUSPENSION — FRONT AND REAR. |

6D-5

Figure 6D-2 GT Exhaust System